

Deburring Machine

ANMA type AG



The design of ANMA deburring machines benefits from more than 30 years of experience with grinding equipment manufacturing.

ANMA AG is provided with special brushes for the deburring of metal components. To obtain perfect results the angle between the brushes and the item must be correct. Therefore ANMA AG machines have adjustable tool rest.

ANMA AG can be provided with 2-speed motors to obtain correct cutting speed for various metals.

Efficient screening and exhaustion connection secures the health of the operator.

Standard equipment:

- Brush of steel, Ø 10"x2".
- Adjustable tool rest.
- Exhaustion connection.

Optional equipment:

- Tool rest for round components.
- Tool rest for sheet metal.
- Complete exhaustion unit with filter bag.
- Socket for mounting on table.

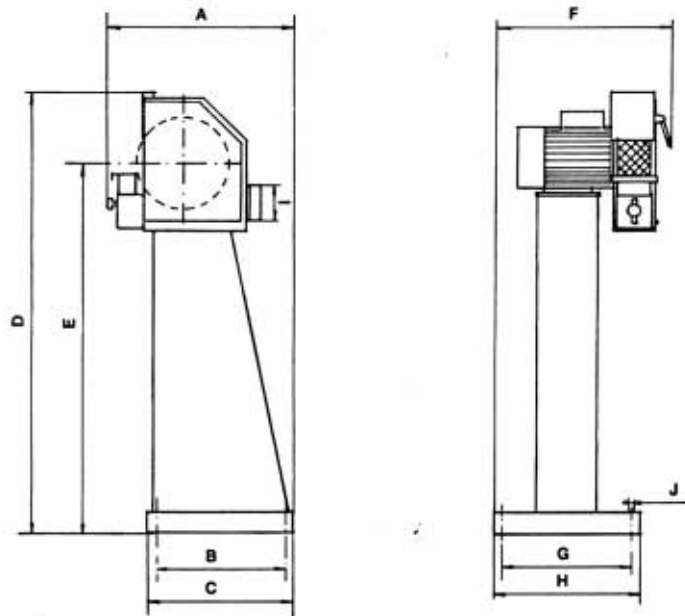

Specifications:

Type	AG 25-45P (2-speed)	
Brushdiameter, max	mm/inch	250 / 10''
Brushwidth, max	mm/inch	60 / 2 ^{3/8} ''
Motor	r.p.m.	2800 - 1400
Motorpower	kW/hp	2,2-1,1 / 3-1,5
Weight	kg / lbs	62 / 136
Weight with exhaust	kg / lbs	77 / 169

Type	AG 25-45	
Brushdiameter, max	mm/inch	250 / 10''
Brushwidth, max	mm/inch	60 / 2 ^{3/8} ''
Motor	r.p.m.	1400
Motorpower	kW/hp	2,2 / 3
Weight	kg / lbs	55 / 121
Weight with exhaust	kg / lbs	77 / 154

Dimensioner: (mm)

Type	A	B	C	D	E	F	G	H	I	J
AG25-45/P	510	340	390	1200	1000	470	340	390	Ø100	Ø11

We reserve the rights to change specifications.



ANMA MASKINFABRIK A/S

Tindbjergvej 4
 DK-8600 Silkeborg
 Tel. +45 86 83 69 22
 Fax. +45 86 83 67 88
 www.anma.dk
 info@anma.dk